



SPIRAL DOUGH MIXER, 184L, 120 KG

Model: Maximat S120

Article no: 9S0749

Power supply: 440V 3Ph ~60Hz

The large curved stainless steel spiral with its special square profile grants you important advantages. The ingredients of your dough are gently handled and are less squeezed between spiral and bowl (minimal warming of the dough). The MAXIMAT square-spiral mixing technology kneads all kinds of dough from the smallest to the largest amount optimally. The result: Easy to process dough of the best quality and working consistency. The SPS-kneading automatic with a continuous temperature reading of the dough is easy to operate. It controls the kneading process by time or temperature, thus helping to obtain constant, optimal dough. By the ergonomically optimized high bowl position, the dough can be taken out conveniently. Cleaning of bowl and spiral become much easier. The transparent bowl cover is ergonomically advantageous as it is possible to watch the kneading process.

MAIN FEATURES

- Advanced Technology
- Automatic Operation
- Rigid Construction
- Painted Housing
- Stainless Steel Bowl and Mixing Spiral
- Two Motors
- With Safety Devices
- Four Space Saving Floor Models
- Easy to Maintain and Clean

Maximat S120, 9S0749

16-01-24 (17:48)

Subject to change without notice
For correct installation, refer to the installation manual

TECHNICAL DATA

Maximat S120, 9S0749, 16-01-24 (17:48)

Model Number Specific	Maximat S120
Voltage (V)	440
Phase	3
Frequency (Hz)	60
Loading (kW)	8,6
Fuse (A)	32
Capacity (L)	184
Capacity, dough (kg)	120
Width, net (mm)	780
Depth, net (mm)	1250
Height, net (mm)	1320
Weight, net (kg)	660
Weight, gross (kg)	790
Volume, net (m3)	1,29
Volume, gross (m3)	1,67
Noise level <(dB)	70
USPH	Yes

Loipart AB (HQ), **Sweden**
Tel. +46 313 920 100, loipart@loipart.se

LMG Finland oy, **Finland**
+358 40 664 6680, lmg@lmg.fi



Loipart USA inc, **USA**
Tel. +1 954 530 5276, loipartusa@loipart.com

Loipart SEA Pte Ltd, **Singapore**
Tel. +65 674 99 100, contact@loipart.sg

Visit us at www.loipart.com

DIMENSIONS

Model: S120 Rev. 1

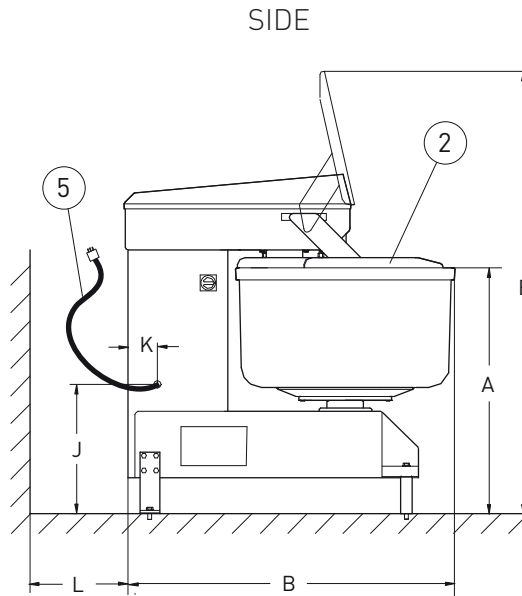
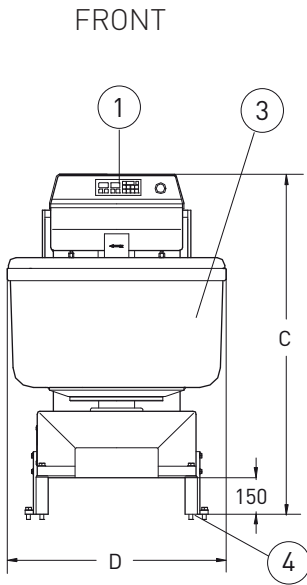

- 1. Control panel
- 2. Bowl cover
- 3. Stainless steel bowl
- 4. Marine feet
- 5. Electrical connection

Marine installation:

The machines are to be secured to the ship deck according to the drawing below and Installation instructions for each machine.

DETAIL MARINE FEET

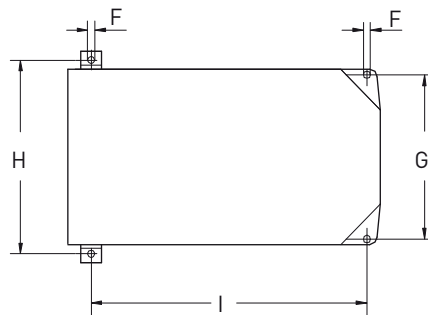

Dimensions (mm)

A	B	C	D	E	F	G	H	I	J	K	L
980	1250	1390	Ø 780	1748	Ø 14	605	720	1000	530	120	min 400