



## ROTARY RACK OVEN

**Model: C100MA**

**Article no: L20021**

**Power supply: 440V 3Ph ~60Hz**

The C100MA is a roll-in rotating rack oven with compact design and high capacity. It is a quiet, energy-efficient and compact oven with high flexibility and designed to fit into small spaces. The rack oven has a max baking temperature of 300°C and bakes even all over the rack creating the perfect baking result. It has integrated high capacity steam system that gives a smooth, crisp crust and for some bread a significantly increased volume.

This model has room for one rack and the oven's smart control panel, and well-conceived design makes it very user-friendly. It has automatic rotation stop, which facilitates unloading, as the rack is always correctly positioned to the door when the oven is open. The spring-loaded door hinges keep the door open during loading and unloading.

Separable and replaceable drainage box makes it possible to change the drainage from the front to the back of the oven. The right-hand hinged insulated door has double glazed window and doorstop. Heating package integrated into the top section –Requires a smaller floor space.

Suspension hook is included in the delivery.

### MAIN FEATURES

- Equipped with the Increased Baking Surface (IBS)
- Built to comply with USPH
- SD Touch II Panel
- User-friendly touch panel with a high-resolution screen
- Efficient insulation -retains the heat inside the oven
- Strong, stainless steel interior och exterior
- Integrated high capacity steam system
- Easy to open
- High efficiency, low heating cost

C100MA, L20021  
22-01-24 (14:03)

Subject to change without notice  
For correct installation, refer to the installation manual

<b>Model Number Specific</b>	C100MA
<b>Voltage (V)</b>	440
<b>Phase</b>	3
<b>Frequency (Hz)</b>	60
<b>Loading (kW)</b>	40
<b>Fuse (A)</b>	63
<b>IP Class</b>	41
<b>Width, net (mm)</b>	1335
<b>Depth, net (mm)</b>	1584
<b>Height, net (mm)</b>	2330
<b>Weight, net (kg)</b>	990
<b>Weight, gross (kg)</b>	1150
<b>Volume, net (m3)</b>	4,93
<b>Volume, gross (m3)</b>	6,41
<b>Connection Cable, length (m)</b>	0
<b>Plug type</b>	None
<b>Certifications</b>	CE
<b>Installation, type</b>	Floor model
<b>Noise level &lt;(dB)</b>	70
<b>Other general information</b>	Damper connection Ø102mm
<b>Oven, type</b>	Baking
<b>Temperature, max (°C)</b>	300
<b>USPH</b>	Yes
<b>Water pressure, max (Bar)</b>	6
<b>Water pressure, min (Bar)</b>	4

**INCLUDED IN DELIVERY**

Suspension hook is included in the delivery.

FRONT

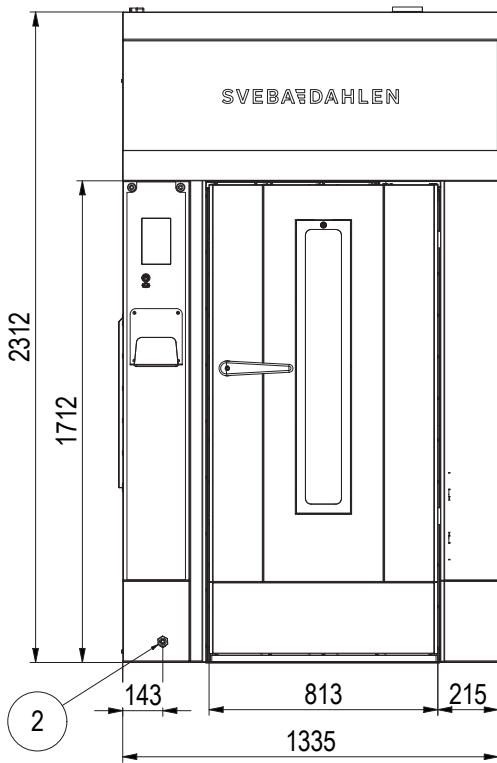

SIDE

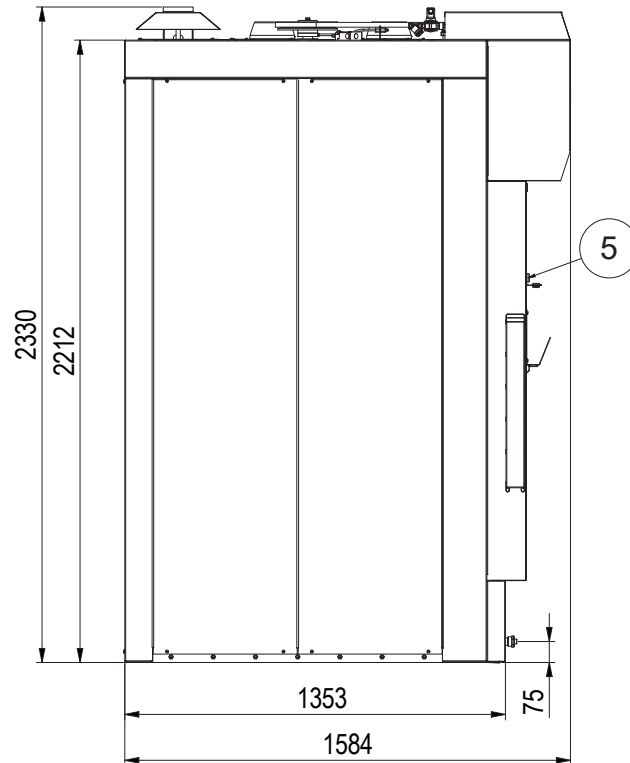

TOP

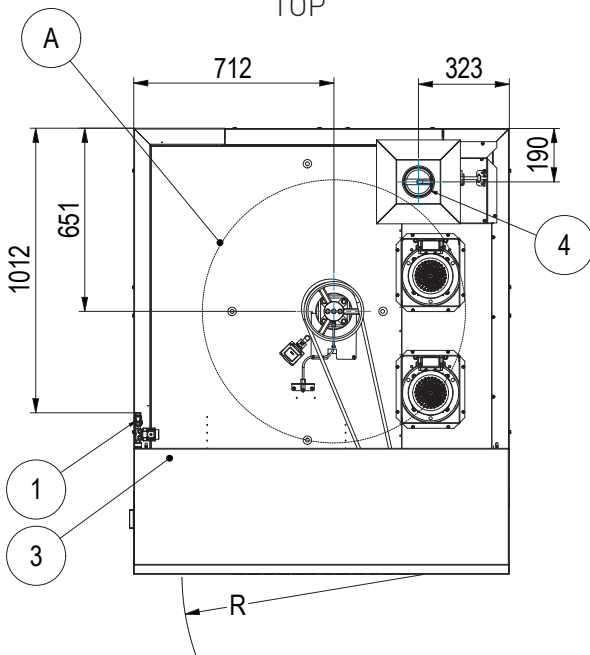

- 1. Water connection
- 2. Condensation drain
- 3. Cable inlet
- 4. Damper connection  $\varnothing$  102mm
- 5. USB connection point

- A. Max. rack diagonal
- R. Door swing radius 860mm

Max. rack height - Cradle 1585mm  
 Max. rack height - Hook 1640mm

