



HOOD TYPE DISHWASHER, INSULATED

Model: EHT8IUSPH6

Article no: 504265

Power supply: 440V 3Ph ~60Hz

This hood type dishwasher is a compact, double skin tank machine with a large capacity of up to 80 baskets per hour. The machine requires only 2 litres of water per washing cycle thus ensuring low energy, water, detergent and rinse aid consumption. Main inside components, as well as the outside panels, are made in AISI 304 stainless steel with smooth surfaces for easy cleaning.

Built-in atmospheric boiler sized to raise incoming water to a minimum of 84 °C for sanitizing rinse.

Built-in drain pump and built-in rinse aid dispenser with automatic initial and continuous cycle loading for a perfect result while minimizing service and maintenance needs.

State-of-the-art electronic controls with built-in programming, self-diagnostics for serviceability and automatic interior self-cleaning cycle.

CLEAR BLUE advanced filtering system provides cleaner wash water and higher active detergent thus ensuring better washing performances and lower running costs. Automatic self-cleaning cycle and self-draining vertical wash pump and boiler to avoid bacteria proliferation. The model is provided with sound and heat insulation and intended for connection to hot water.

MAIN FEATURES

- Heavy-duty stainless steel 304 construction
- Drain pump
- Built-in rinse aid dispenser
- 80 baskets/hour capacity
- Double skin hood (insulated)
- Low water and detergent consumption
- Built-in atmospheric boiler
- Automatic cleaning cycle
- Built to comply with USPH

EHT8IUSPH6, 504265

15-01-24 (15:18)

Subject to change without notice
For correct installation, refer to the installation manual

Model Number Specific	EHT8IUSPH6
Voltage (V)	440
Phase	3
Frequency (Hz)	60
Loading (kW)	9,9
Max Amps in Phase (A)	14,5
IP Class	X5
Capacity, max (racks/h)	80
Width, net (mm)	752
Depth, net (mm)	755
Height, net (mm)	1567
Weight, net (kg)	117
Weight, gross (kg)	129
Volume, net (m3)	0,89
Volume, gross (m3)	1,16
Connection Cable, length (m)	0
Plug type	None
Atmospheric boiler	Yes
Certifications	CE
Connection height, water (mm)	300
Cycle time (s)	45
Detergent pump incl.	No
Dishwashing racks	1
Drain pipe, diameter (")	3/4
Drain pipe, diameter (mm)	20
Drain pump	Yes
Electronic control	Yes
Energy saving device	No
Feeding, type	Batch
Hardness, max (dH°)	8
Hot water inlet temperature (°C)	10-65
Hot water inlet, diameter (")	3/4
Installation, type	Floor model
Marine feet	Yes

Noise level <(dB)	63
Rinse pump incl.	Yes
Rinse temperature (°C)	84
Temperature, max (°C)	84
USPH	Yes
Water consumption (L/cycle)	2
Water pressure, max (Bar)	7
Water pressure, min (Bar)	0,5

INCLUDED IN DELIVERY

1 rack for 18 dinner plates, 1 rack for cups (48 small or 24 common) and 2 yellow cutlery holders

DIMENSIONS

Model: EHT8IUSPH Rev. 1

FRONT

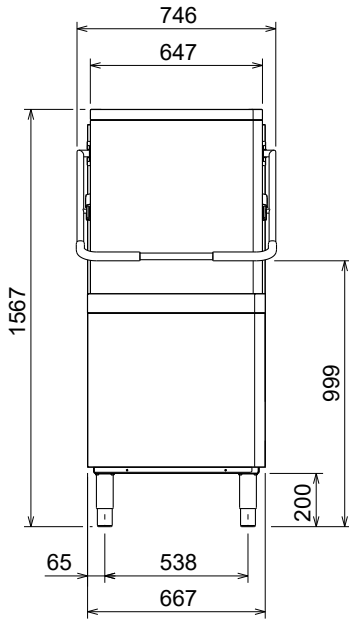

SIDE

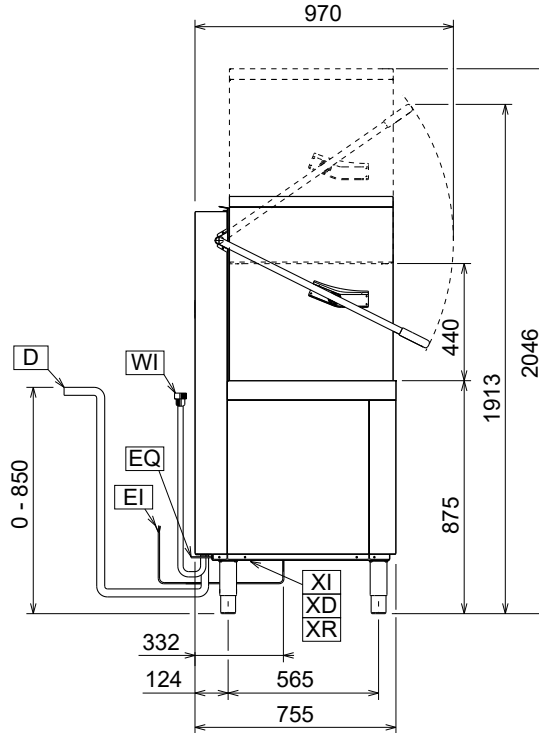

TOP

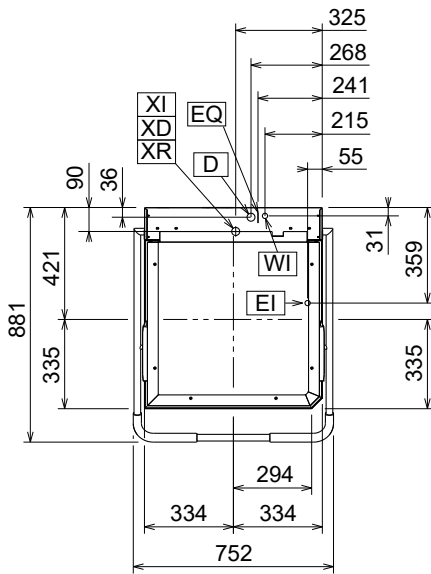

- A Control panel
- B Marine foot
- WI Hot water connection G 3/4 , inlet hose 2100 mm.
- D Drain connection Ø 20.5
- EI Electrical connection
- XD Connection for detergent dispenser
- XI Chemicals inlet
- XR Connection for rinse aid
- EQ Equipotential screw (earth screw)

Control panel A:

1. ON/OFF
2. tank temp. indicator light
3. water tap indicator light
4. boiler temp. indicator light
5. wash cycle 1
6. wash cycle 2
7. wash cycle 3
8. HP or ETL mode
9. drain
10. delime cycle
11. active/wash safe control



Corner flow

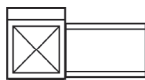

Straight flow

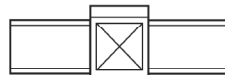

The machine can be installed for straight or corner flow installation. All service procedures can be carried out from the front of the machine.

Detail of marine leg B (height adjustable +35-20 mm)

